

◆ Operation Panel

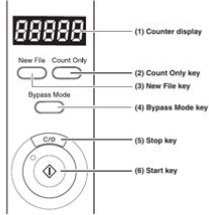

- (1) **Counter display**
Displays an error code or the number of pages scanned.
To clear the number on the counter display, press the [Count Only] key, then press the [Stop] key down for at least two seconds.
- (2) **Count Only key**
Sets the scanner to the Count Only mode for just counting the number of pages fed. (See p.52.)
When you press this key, it will light. If you place the document and press the Start key in this state, the document will be fed and the scanner will count the number of pages. (The document will not be scanned.)
- (3) **New File key**
Enabled when the application supports the "Batch Separator" function. This key lights when it is pressed, or when the batch separator has been set in the application. When this function is in use, scanned images will be saved to a separate file or folder from that of the preceding images.
- (4) **Bypass Mode key**
Press this key to set the scanner to the Bypass (manual) mode. Use this function to scan documents that might double feed or that are bound at the edge and to be fed without page separation.
- (5) **Stop key**
Press this key to stop scanning.
Also use this key to cancel the currently set mode, or to clear the number of pages scanned or cancel an error on the counter display.
- (6) **Start key**
LED will light when the Count Only mode is selected or the application has activated the scanner. Press the [Start] key when the LED is lit to start scanning.

15

File Name: canon dr-9080c repair manual.pdf

Size: 3015 KB

Type: PDF, ePub, eBook

Category: Book

Uploaded: 20 May 2019, 22:30 PM

Rating: 4.6/5 from 792 votes.

Status: AVAILABLE

Last checked: 2 Minutes ago!

In order to read or download canon dr-9080c repair manual ebook, you need to create a FREE account.

[**Download Now!**](#)

eBook includes PDF, ePub and Kindle version

[Register a free 1 month Trial Account.](#)

[Download as many books as you like \(Personal use\)](#)

[Cancel the membership at any time if not satisfied.](#)

[Join Over 80000 Happy Readers](#)

Book Descriptions:

We have made it easy for you to find a PDF Ebooks without any digging. And by having access to our ebooks online or by storing it on your computer, you have convenient answers with canon dr-9080c repair manual . To get started finding canon dr-9080c repair manual , you are right to find our website which has a comprehensive collection of manuals listed.

Our library is the biggest of these that have literally hundreds of thousands of different products represented.



Book Descriptions:

canon dr-9080c repair manual



Use of this manual should be strictly supervised to avoid disclosure confidential information. Quality Assurance Center Canon Electronics Inc. The detailed conditions including JPEG value are omitted for grayscale and color, and may differ depending on function settings, the personal computer used, and other conditions. The color function is available only with the DR9080C. Table 1203b 4. Finish the operation. Quit the application software. Turn the personal computer OFF. Be careful not to wipe or touch the electrical contact Feed roller part when wiping the ink. DESCRIPTION OF main CPU PCB for the DR9080C and the DR6080. The only difference between the ELECTRICAL DR9080C and the DR6080 is the number of 256M bit SDRAM chips. Table 2401 lists the CIRCUITS function of each IC shown in the block diagram. The main types of image processing are described below. Staple photosensor GRID2 Document guide width Detecting the width of documents. Shading solenoid Lower Activating the shading plate of the front reading side unit. DC power supply PCB Supplying DC power. However, the fixing should not be tightened too much. Fix them using cable clamps. After reassembly, check that the document guide moves smoothly. For details, refer to the users manual. Check if the machine operates normally. Note The upper delivery cover assembly should be installed with the imprinter cover opened. Install a leaf spring at each side with a screw. Mechanical counter unit Screw M3x6 Remove the upper delivery assembly. Endorser cover, imprinter cover, and upper unit are open. Cant communicate with CPU for imprinter. Cant communicate with CPU for ultrasonic double feed detection. Check the operation of the pickup sensor. Check the connection of the motors and gears. Each time Count Only is pressed, the data changes. These Bulletins should be read carefully. After you finish reading this manual, store it in a safe place for future reference. <http://fcsafaris.com/Uploads/dometic-rm-2604-service-manual.xml>

- **canon dr 9080c parts manual, canon dr 9080c service manual, 1.0, canon dr 9080c parts manual, canon dr 9080c service manual.**

◆ Operation Panel

1

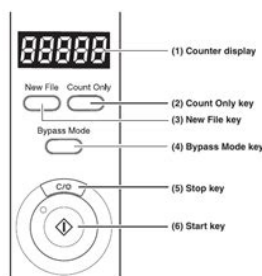
**(1) Counter display**

Displays an error code or the number of pages scanned. To clear the number on the counter display, press the [Count Only] key, then press the [Stop] key down for at least two seconds.

(2) Count Only key

Sets the scanner to the Count Only mode for just counting the number of pages fed. (See p.52.) When you press this key, it will light. If you place the document and press the Start key in this state, the document will be fed and the scanner will count the number of pages. (The document will not be scanned.)

(3) New File key

Enabled when the application supports the "Batch Separator" function. This key lights when it is pressed, or when the batch separator has been set in the application. When this function is in use, scanned images will be saved to a separate file or folder from that of the preceding images.

(4) Bypass Mode key

Press this key to set the scanner to the Bypass (manual) mode. Use this function to scan documents that might double feed or that are bound at the edge and to be fed without page separation.

(5) Stop key

Press this key to stop scanning. Also use this key to cancel the currently set mode, or to clear the number of pages scanned or cancel an error on the counter display.

(6) Start key

LED will light when the Count Only mode is selected or the application has activated the scanner. Press the [Start] key when the LED is lit to start scanning.

15

These limits are designed to provide reasonable protection against harmful interference in a residential installation. However, Canon Electronics Inc. Please read this manual thoroughly before operating the machine in order to familiarize yourself with its capabilities, and to make the most of its many functions. After reading this manual, store it in a safe place for future reference. The scanner may tip or fall over, and cause an injury. Do not plug the scanner into an outlet shared with another device. If you use an extension cable, pay attention to the total amperage of the cable. Make sure that you have everything. Check every item you have removed from the box. If any items are missing, contact your sales representative. Connectors Air Vent To avoid overheating and causing a fire, never block the air vents on the rear of the scanner. Use the method that is compatible with your computer system. I Do not turn OFF the scanner or remove any interface cables when an application is running. CAUTION I Do not connect both SCSI and USB interface cables at the same time. Connect your computer to the scanner using the SCSI cable. Do not select 7 Important as this is normally assigned to the SCSI controller. If a SCSI hard disk is mounted, do not use 0 and 1. CAUTION SCSI Connectors USB Connector cannot be connected USB Interface Cable Connecting the Power Cord Connect the power cord. Preparing the Document Tray Extension Pull out the document tray extension to accommodate the size of the document to be scanned. N Long Documents If the document you are scanning is long, open the document eject tray extension and adjust the position of the stopper as needed. Lift up the stopper. Adjust the position of the stopper to match the length of the document. G The displayed device name of the DR6080 or DR9080C differs depending on the connection, via SCSI or via USB. <http://vivo-mebel.ru/upload/dometic-rm-2804-manual.xml>

◆ Operation Panel

1

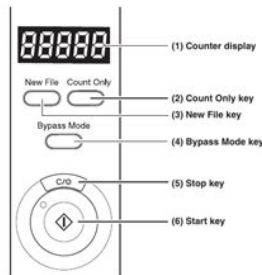
**(1) Counter display**

Displays an error code or the number of pages scanned. To clear the number on the counter display, press the [Count Only] key, then press the [Stop] key down for at least two seconds.

(2) Count Only key

Sets the scanner to the Count Only mode for just counting the number of pages fed. (See p.52.) When you press this key, it will light. If you place the document and press the Start key in this state, the document will be fed and the scanner will count the number of pages. (The document will not be scanned.)

(3) New File key

Enabled when the application supports the "Batch Separator" function. This key lights when it is pressed, or when the batch separator has been set in the application. When this function is in use, scanned images will be saved to a separate file or folder from that of the preceding images.

(4) Bypass Mode key

Press this key to set the scanner to the Bypass (manual) mode. Use this function to scan documents that might double feed or that are bound at the edge and to be fed without page separation.

(5) Stop key

Press this key to stop scanning. Also use this key to cancel the currently set mode, or to clear the number of pages scanned or cancel an error on the counter display.

(6) Start key

LED will light when the Count Only mode is selected or the application has activated the scanner. Press the [Start] key when the LED is lit to start scanning.

15

Turn OFF the power to the scanner and the computer before changing the connections, and then turn ON the power and let the computer recognize the scanner again. To turn OFF the scanner, press the power switch. I Wait at least 10 seconds before turning ON the scanner again. I For your safety, disconnect the power plug from the power outlet if you are not CAUTION using the scanner for a long time. Be sure to open and read the Readme.txt file on the setup disc before installing the software. G If another ISIS compatible driver is already installed on the computer, be sure to make a backup of the following file. The installation starts. Follow the instructions on the screen to complete the installation. Installing CapturePerfect Connect the scanner to the computer. Turn ON your computer and start Windows. Be sure to log on as an administrator if your system is Windows NT 4.0 Workstation, Important Windows 2000 Professional, or Windows XP. The installation starts. Follow the instructions on the screen to complete the installation. G Be sure to log on as an administrator if your system is Windows NT 4.0 Workstation, Windows 2000 Professional, or Windows XP. Important G The dialogs and button names in Windows XP are different from those used in the explanations in this manual. If you selected "CapturePerfect 2.0," the above dialog box appears. Treat the documents carefully. The paper edges may cut your fingers. The ranges of width and length for a document are Width 55 to 305 mm. Align a batch of documents to be scanned until the edges are even. Place the document face up in the document tray, aligning the documents top edge against the back of the document tray. When scanning ends, the document tray is lowered. If paper feed stops during scanning due to a system error or paper jam, make sure that the last page of the document was recorded properly before continuing to scan.

Note N PanelFeeding To use the panelfeeding mode, instruct the scanner to start from the application. Instruct scanning to start from the application. The Start key changes color from red to green. The document tray rises, and scanning begins. When scanning ends, the document tray is lowered. The document tray rises, and scanning begins. When scanning ends, the document tray is lowered. I If the scanning mode is set to "Automatic Feeding,". Place the first page of the document face up in the document tray, aligning the document's top edge against the back of the document tray. Be careful not to pinch your fingers in the document tray. CAUTION Instruct scanning to start from in the application. Place the next page of the document face up in the document tray, aligning

the document's top edge against the back of the document tray. Count Only key The Count Only key lights to indicate the Count Only mode. The result varies depending on the pattern. G PATCH T FILE A When this sheet is recognized, the document following the sheet is saved to a separate file. Place the patch code sheet on top of the documents that are to be saved to a separate file. Double Feed Detection Function The scanner automatically detects two pages that have been fed at the same time double feed and displays an error code that means "Double feed detection". G Operation panel buzzer setting U010 Do not sound buzzer during key operation. U011 Sound buzzer during key operation default. G Count Only mode setting U020 Do not use the endorser in the Count Only mode default. U101 Long Document mode Length of document is 1,000 mm or less. When using the Long Document mode, if you place a long document askew in the document tray, it will rub against both sides of the feeding path and may damage the Note document. Remedy the problem by following the procedure for the respective cause. SCSI Connections Cause The scanner is not correctly connected.

◆ Operation Panel

1

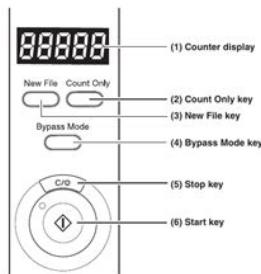

- (1) Counter display**
Displays an error code or the number of pages scanned.
To clear the number on the counter display, press the [Count Only] key, then press the [Stop] key down for at least two seconds.
- (2) Count Only key**
Sets the scanner to the Count Only mode for just counting the number of pages fed. (See p.52.)
When you press this key, it will light. If you place the document and press the Start key in this state, the document will be fed and the scanner will count the number of pages. (The document will not be scanned.)
- (3) New File key**
Enabled when the application supports the "Batch Separator" function. This key lights when it is pressed, or when the batch separator has been set in the application. When this function is in use, scanned images will be saved to a separate file or folder from that of the preceding images.
- (4) Bypass Mode key**
Press this key to set the scanner to the Bypass (manual) mode. Use this function to scan documents that might double feed or that are bound at the edge and to be fed without page separation.
- (5) Stop key**
Press this key to stop scanning.
Also use this key to cancel the currently set mode, or to clear the number of pages scanned or cancel an error on the counter display.
- (6) Start key**
LED will light when the Count Only mode is selected or the application has activated the scanner. Press the [Start] key when the LED is lit to start scanning.

<http://gbb.global/blog/bosch-heat-gun-manual>

Remedy Connect the SCSI cables to the scanner in the correct way. Remedy Check the SCSI ID of all connected SCSI devices, and make sure that the same SCSI ID is not set to two or more devices. Reset the SCSI IDs if the same SCSI ID is set. Remedy Connect the scanner correctly with a cable that supports USB 2.0. Cause The USB 2.0 interface card is not correctly installed to the computer. Remedy Refer to the USB 2.0 interface card operation manual and install it correctly. I Be careful when you clear a paper jam. You may be injured unexpectedly. For example, the paper edges may cut your fingers, or the document may be damaged. Remove the jammed paper from inside the scanner. Do not force the upper scanner down. Doing so might damage the scanner. Press the upper scanner down firmly on both sides to close it. If you press the upper scanner down only on one side, the opposite side will not be fully closed. Close the document eject tray extension if it is open. Lift up the upper scanner slightly. Press the upper scanner down firmly on both sides to close it. If you press the upper scanner down only on one side, the opposite side will not be fully closed. Make sure

that you hear it click into place. Condition Paper jam has occurred. Cause and remedy This is because ink is sticking to the holes on the guide plate inside of the imprinter. Clean these holes with a cotton wool swab. Check the following and take the appropriate action. The following describes error codes that appear on the counter display and how to remedy the error. Remedy Close the imprinter cover and endorser ED600 cover. Error code Cause The upper scanner, imprinter cover, and endorser ED600 cover are open with the optional imprinter and endorser ED600 installed. Remedy Open the upper scanner and remove the document. Check to see if the document was scanned correctly, and scan the document again. Error code Cause Staple detected, document feed stopped.

<http://gromoga.com/images/bsa-leave-no-trace-trainer-course-manual.pdf>

Appendix 5

5. Wiring Diagrams

Collision Warning System with Side Object Detection

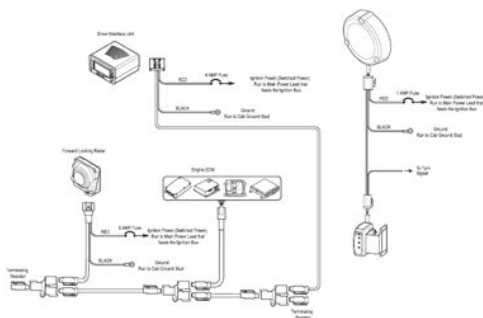

Error code Cause Number of document sheets to be scanned exceeds set number of sheets in the verify scan. I Before you clean the scanner, turn OFF the scanner and computer and disconnect the power cord from the power outlet. Otherwise, it might cause an electrical shock. CAUTION I Never clean the scanner with any kind of organic solvent, such as alcohol, benzene, or paint thinner. Clean the sensor periodically so that dust and debris do not collect on it. Sensor Cleaning the Scanning Glasses and Rollers A probable cause of stripes appearing on scanned images or dirt appearing on scanned documents is dirt on the scanning glasses or rollers. Be sure to clean both scanning glasses, the one below and one above. Never spray mild detergent or water directly on the scanning glasses. The spray could penetrate below the glass and contaminate the internal light source and CAUTION lenses. Rollers are located at the positions indicated in the figure below. Pickup Rollers Feed Rollers Feeding Rollers Platen Rollers Retard Rollers Remove the pickup roller, retard roller, and feed roller. See "Installing and Removing the Rollers,". Press the upper scanner down firmly on both sides to close it. If you press the upper scanner down only on one side, the opposite side will not be fully closed. If this happens, clean the shading plates. The power to the scanner is ON when you are cleaning the shading plates so be very careful. The shading plates retract. Carefully close the upper scanner. If you press the upper scanner down only on one side, the opposite side will not be fully closed. Clean off the ink with water and a mild detergent on a soft cloth that has been firmly wrung,

and then thoroughly dry it with a dry cloth. The feed rollers need to be changed periodically to maintain scanning quality. When to Replace the Rollers If the total number of scanned documents exceeds 250,000, a message for roller replacement appears when you restart the computer.

<https://artoftheark.com/images/bsa-leadership-training-manual.pdf>



G The displayed dialog box differs depending on which Windows operating system Note you are using. I Turn OFF the power to the scanner and unplug the power cord from the power outlet when you remove or install the rollers. Open the roller cover. Open the roller holder and remove the pickup rollers. Position the square axle of the pickup roller on the left and insert the new pickup rollers. Firmly close the roller cover until you hear it click. If the roller holder and roller cover are not firmly closed it will cause a feed error. Always be sure to check that the roller holder and roller cover are closed. Open the roller cover. Pull the lever that locks the feed rollers in place towards you. Slide the feed rollers to the right, and then pull them towards you. Place the new feed rollers on the pin. Set the feed rollers in place q, and align the notch in the roller's axle with the shaft on the scanner w. Firmly close the roller cover until you hear it click. If the roller cover is not firmly closed it will cause a feed error. Always be sure to check that the roller cover is closed. Press the hook upwards and remove the roller cover. Lift the roller clamp lever q and slide it to the left w. Set the new retard rollers in place, and align the notch in the roller's axle with the shaft on the scanner. Slide the roller clamp lever to the right, and push it into the hole in the retard rollers. Put back the roller cover. I Be sure that the hook is completely latched and the roller cover is not loose. If the roller cover is loose, the document tray will catch on it causing the scanner to CAUTION not operate correctly. Remove these screws x6. Press here for open the imprinter cover. Remove this screw. Remove these screws x6. Retaining ring. This page requires Javascript. Modify your browsers settings to allow Javascript to execute. See your browsers documentation for specific instructions. To install your download click on the name of the downloaded file.

The driver may be included in your OS or you may not need a driver. Recommended Drivers File Name Date File Size Optional Drivers File Name Date File Size Recommended Software File Name Date File Size Optional Software File Name Date File Size Recommended Manuals File Name Date File Size Optional Manuals File Name Date File Size. Book marked chapters for straightforward navigation enabling you to determine Download User Manual Canon DR9080C Color Production Scanner Service Manuals, User Guide, Reviews, Instruction Manuals and Owners Manuals. The

Canon DR9080C is the top end scanner in the DR series. It is a very powerful input tool engineered to handle large decentralized scanning tasks as well as Download and Read Canon Dr 6080 Dr 9080c Service Manual learning the sound of music 2013 television broadcast vocal selections this star wont go out the life and words of Download drivers, software, firmware and manuals for your DR 9080C. Online technical support, troubleshooting and howtos. Download drivers, software, firmware and manuals for your DR 9080C. Online technical support, troubleshooting and howtos. Download and Read Canon Dr 6080 And Dr 9080c Document Scanner Service Manual.Reload to refresh your session. Reload to refresh your session. And by having access to our ebooks online or by storing it on your computer, you have convenient answers with Dr 9080 Service Manual. To get started finding Dr 9080 Service Manual, you are right to find our website which has a comprehensive collection of manuals listed. Our library is the biggest of these that have literally hundreds of thousands of different products represented. I get my most wanted eBook Many thanks If there is a survey it only takes 5 minutes, try any survey which works for you. Register now! If this is a gift, consider shipping to a different address. For complete online shopping and ordering or for current price and availability, please visit our eStore.

<http://aliancegroup.su/wp-content/plugins/formcraft/file-upload/server/content/files/162713f49653b3---bpl-prima-tv-manual.pdf>

The summary below lists just a portion of the detailed product information that may be found by visiting our eStore. CANON Price List as of 18 Jul 2018 lumix zs19 owners manual farmall parts super m mv md mdv m ta catalog manual tc 46 ih The following table summarizes the devices supported by sanebackends1.0.27239g0af6149adirty. This is only a summary. Please consult the manpages and the authorsupplied webpages for more detailed and usually important information concerning each backend.Production Scanner. DR 6080 Scanner pdf manual download. Also for Dr 9080c. Turn OFF the power, contact your service representative, and notify them of the error code. Check to see if the document was scanned correctly, and scan the document again. Order by 330 PM MST today and orders up to that quantity will ship today.Order by 330 PM MST today and orders up to that quantity will ship today.Please call us for the most accurate information.Please contact us for options. Precision Roller is in no way affiliated, sponsored or endorsed by these copyright owners or their affiliates or dealers This website uses a secure server to encrypt all sensitive information. Please use the box above to search for any other information.Cause and remedyIf the document cannot be a probable cause. If the scanned image is foggy or the document is not scanned at all, brightness is set too high. If the above remedies do not rectify the problem, contact your service representative.Open the scanner and remove the document. Open the scanner and remove the document. J01. Staple detected, document transfer stopped. Sometimes this may coincide with a flashing light on the front of the computer or an indicator on the. Discover everything Scribd has to offer, including books and audiobooks from major publishers. Start Free Trial Cancel anytime.

Report this Document Download Now save Save DR6080,DR9080C For Later 0 ratings 0% found this document useful 0 votes 59 views 366 pages DR6080,DR9080C Uploaded by Renee Description Canon Scanner DR6080, DR9080C Service Manual Full description save Save DR6080,DR9080C For Later 0% 0% found this document useful, Mark this document as useful 0% 0% found this document not useful, Mark this document as not useful Embed Share Print Download Now Jump to Page You are on page 1 of 366 Search inside document Browse Books Site Directory Site Language English Change Language English Change Language. After you finishAs an ENERGY STAR partner, Canon Electronics Inc.ENERGY STAR guidelines for energy efficiency. The International ENERGY STAR Office Equipment Program is an international program that promotesThe program backs theIt is an open system in which business proprietors can participate voluntarily. The targetedFCC REGULATIONS For 120V models. This equipment has been tested and found to comply with the limits for a Class A digital device, pursuant to Part 15 of the FCC. Rules. These limits are designed to

provide reasonable protection against harmful interference when the equipment isThis equipment generates, uses, and can radiate radio frequency energy and, if notOperation of this equipment in a residential area is likely to cause harmful interference in which case the user will be requiredDo not make any changes or modifications to the equipment unless otherwise specified in the manual. If such changes orRADIO INTERFERENCE REGULATIONS For 120V models. This digital apparatus does not exceed the Class A limits for radio noise emissions from digital apparatus as set out in the. Interferencecausing equipment standard entitled "Digital Apparatus", ICES003 of the Industry Canada. REGLEMENT SUR LE BROUILLAGE RADIOELECTRIQUE For 120V models. Cet appareil numerique respecte les limites de bruits radioelectriques applicables aux appareils numeriques de Classe AFur EMVG.

Dieses Produkt ist zum Gebrauch im Wohnbereich, Geschäftsund Gewerbebereich sowie in Kleinbetrieben vorgesehen.All rights reserved. No part of this publication may be reproduced,However, Canon Electronics Inc.Trademarks and Registered TrademarksYou shall not assign, sublicense, sell, rent, lease, loan, convey or transfer to any third party, or send or bring the SOFTWARE out of the countryExcept as expressly permitted under the applicable law, you shall not alter, modify, disassemble, decompile or otherwise reverse engineer the. SOFTWARE or accompanying documentation and you also shall not have any third party to do so.Except as expressly permitted under the applicable law,You must reproduce and include the copyright notice on the backup copy.SOFTWARE. No updates, fixes or support will be made available for the SOFTWARE.The limited warranty does not apply if the failure of the diskette resultedYou may terminate this. Agreement by destroying the SOFTWARE and any copy thereof. This Agreement will also terminate if you fail to comply with any of the terms of this. Agreement. In addition to Canon enforcing its respective legal rights, you must then promptly destroy the SOFTWARE and any copy thereof.Use, duplication orAgreement shall remain in full force and effect.Conventions. This manual uses the following symbols and indications. Before you start reading this manual, read the following and familiarize yourselfFailure to observe the instructions provided in a warning could result in death or seriousFailure to observe the instructions provided in a caution notice could result in seriousImportant. These important notes contain important information on procedures that must beFailure to observe a request could result inNote. Notes provide additional tips or advice that can save you time and effort in using theSafety Precautions.5. Daily Maintenance. Installation Location. Power Supply. Carrying.Chapter 2 Preparation Before UseSCSI Connections.USB Connections.

Connecting the Power Cord.Preparing the Document Tray Extension. Preparing the Document Eject Tray Extension.Recognizing the Scanner. 28. Turning OFF the Power. 30. Chapter 3 SoftwareInstalling CapturePerfect. 34How to Use CapturePerfect.Chapter 4 Document Feeding and ScanningTypes of Documents. 42. How to Place Documents. 43Scan Procedure.Count Only Mode. Using Patch Code Sheets.Double Feed Detection Function. 58. Skew Detection Function. 58. Staple Detection. 59How to Set the User Mode. 62. Chapter 6 TroubleshootingSCSI Connections. 64. USB Connections. 66Paper Jam in the Paper Feed Unit. 67. Paper Jam in the Paper Exit Section. 70Chapter 7 Daily CleaningCleaning the Main Unit. Cleaning the Document Detection Sensor. Cleaning the Scanning Glasses and Rollers. Cleaning the Shading Plates. Cleaning the Guide Plate When Using the Imprinter. Cleaning the Ink Jet Nozzles When Using the Imprinter. Power Outlet.When to Replace Rollers. Resetting the Counter. Installing and Removing the Rollers.Specifications for the Scanner. Options. Consumables. Exterior Dimensions.Daily Maintenance. When you are working around the scanner, follow these precautions to avoid theConnect theCall for service immediately. Avoid shocks and vibrations to the scanner caused byOFF the power immediately and disconnect the power cord from the power outlet. Call for service immediately.If you accidentally spill liquid or drop aCall for service immediately. Doing so might cause a fire orSuch objects may tip or fall over,Never attempt toDoing so might expose orFor example, the paper edges may cut your fingers. Doing so might result in a malfunction or

injury. More than For operation, maintenance and ventilation, make sure that there is enough space. Avoid placing the scanner in the following places. Doing so may cause a If installation in such places is unavoidable, provide a curtain or similar object to Dust and cigarette fumes adversely affect the components inside the scanner.

Condensation occurring inside the scanner may impair scan image quality. Place Room temperature. Relative humidity Use the recommended operating environment for the ink cartridge when using If you use an When you remove the power cord, grip it by the plug Carrying. Take care when moving the scanner. Two people should hold the scanner firmly This chapter describes the features of the Front View. Rear View. Connectors Bottom View. Operation Panel. Supports black and white binary, and grayscale. Small documents, such as checks and business cards, all the way up to Document skew is automatically aligned as it The scanner accurately handles documents of The scanner detects double fed documents. The scanner detects stapled documents. This function automatically detects if the document is fed in at an angle, and The scanner has high durability of six million scans. This function enables drop out scanning of that is, "drops out" a specific color The wide range of options includes the imprinter for printing characters on the Packaging. What Is in the Box Make sure that you have everything. Check every item you have removed from the Power Cord. Setup Disc Guide. USB Cable. Warranty Card This section describes the names and functions of each part. Before you connect Document Eject Tray Guide. Imprinter Cover. Set this guide to the width of the Open out this cover when you are Use this if documents look like they are going to Operation Panel Document Guide. Set the paper guide for the Upper Scanner. Open the upper scanner Power Switch Extension Wire. Pull this out and use it if documents extend Document Tray. Place the document in Do not open the imprinter cover when the optional imprinter is not installed. Power Cord Connector. Connectors. Connect the power cord provided with Air Vent SCSI Connectors. DIP Switch. Connect a HiSpeed USB 2.0 Connect a halfpitch 50 pin pin type. SCSI cable. See p.19.. This switch is for setting the SCSI ID Displays an error code or the number of pages scanned.

Sets the scanner to the Count Only mode for just counting the number of When you press this key, it will light. If you place the document and press the. Start key in this state, the document will be fed and the scanner will count the Enabled when the application supports the "Batch Separator" function. This Press this key to set the scanner to the Bypass manual mode. Use this Press this key to stop scanning. Also use this key to cancel the currently set mode, or to clear the number of LED will light when the Count Only mode is selected or the application has Optional Products The imprinter unit is installed inside the scanner, and prints a text message on the You can set the text message that is Note. Ink cartridges used are Hewlett Packard ink cartridges, and the model numbers are. C6602B blue, C6602G green, and C6602R red. The Endorser ED600 unit is installed on top of the scanner, and prints a eight Note. When using the endorser, the scanning speed lowers to match the printing speed of the The hard counter is a seven digit counter that is installed inside the upper HELP" for more information. Preparation Before Use. This chapter describes the procedure from Environment. 18 SCSI Connections. 19. USB Connections. 22. Connecting the Power Cord. 23 Eject. 24. Preparing the Document Tray. Extension. 24. Preparing the Document Eject Tray. Extension. 25. Turning ON the Power. 27. Recognizing the Scanner. 28. Turning OFF the Power. 30 Preparation Before Use. Checking Your Operating. Environment. Your computer system must meet the following conditions to use the For SCSI. For USB Important Contact your sales Connecting to a Computer. There are two ways to connect the scanner to your computer, SCSI or USB. Use SCSI Connections. Connect the scanner to the computer. Note. To connect the scanner with a SCSI cable, you will need the following items that are not Check that the SCSI card is installed on your computer. Use one of the recommended SCSI cards.

The scanner's SCSI connector is a halfpitch 50 pin pin type connector. Check the Be sure to use one of the recommended SCSI cards when connecting the The recommended SCSI cards are listed below.

Recommended SCSI cards. Manufacturer. Adaptec. Product names AHA2930U, AHA2940AU, AHA2930LP, ASC19160, Preparation Before Use

Connect your computer to the scanner using the SCSI cable. Two SCSI connectors are located on the rear of the scanner. Insert the SCSI To connect another SCSI device to the computer, insert the other SCSI cable into USB Connector SCSI Cable Set the SCSI ID and the terminator on the DIP switches located between the. SCSI connectors and the power cord connector. Move the DIP switch towards you to turn it OFF and move it towards the scanner SCSI ID switch Set unique SCSI IDs to any other builtin SCSI devices or SCSI devices Important Do not select 7 If a SCSI hard disk is mounted, do Set the terminator on the last SCSI device on a daisy chain to ON. In such a connection, be sure to set the terminator on all other SCSI devices to Terminator OFF In such a connection, set the terminator on the SCSI device connected as the end Terminator ON, or Terminator OFF Note that if you use a terminator plug and the. DIP switch is set to ON, the scanner may malfunction.

Preparation Before Use. USB Connections. Important. To connect the scanner with a USB interface cable, you will need the following items Use an extended USB interface card that is compatible with HiSpeed USB 2.0 and Be sure to use one of the recommended USB 2.0 interface cards when The recommended USB 2.0 Recommended USB 2.0 interface cards. Product. USB 2 Connect 2000LP AUA2000. USB 2 Connect 3100 AUA3100LP. USB 2 Connect 5100 AUA5100. USB 2 Connect for Notebooks AUA1420. Important Use a SCSI cable to connect Do not connect both a SCSI cable and USB interface cable at the same time. SCSI Connectors Connecting the Power Cord. Connect the power cord. Be sure to use only the power cord provided with the scanner.

<https://www.becompta.be/emploi/bosch-heat-gun-manual>